

# **M3 Junction 9 Improvement**

**Scheme Number: TR010055**

## **2.11 Traffic Regulation Measures Plans**

**APFP Regulation 5(2)(o)**

**Planning Act 2008**

**Infrastructure Planning (Applications: Prescribed Forms and  
Procedure) Regulations 2009**

**Volume 2**

**November 2022**



NOTES  
 Purpose of use  
**APPLICATION SUBMISSION**  
 Development Consent Order Number / Document  
 TR010055/2.11

1. THIS DRAWING HAS BEEN PRODUCED USING CAD SOFTWARE. THEREFORE ALL DIMENSIONS ARE SHOWN IN METRES UNLESS SHOWN OTHERWISE.  
 2. DO NOT SCALE FROM THIS DRAWING. USE ONLY PRINTED DIMENSIONS.

KEY TO SYMBOLS  
 DEVELOPMENT CONSENT ORDER BOUNDARY

REV	DATE	REVISION NOTE	ORIG	CHKD	APPD
0	NOVEMBER 2022	APPLICATION SUBMISSION	GP	LC	MF

DESIGNER  

CONTRACTOR  

CLIENT  

PROJECT TITLE  
 M3 JUNCTION 9 IMPROVEMENT SCHEME

PROJECT STAGE  
 PCF STAGE 3

DRAWING TITLE  
 TRAFFIC REGULATION MEASURES  
 APFP REGULATION S(2)(c)  
 KEY PLAN  
 DOCUMENT REFERENCE: 2.11

SUITABILITY  
 APPLICATION SUBMISSION

SHEET SIZE: A1 SCALE: 1:12500 STATUS: REV 0  
 DRAWING NUMBER  
 HES51511-VFK-LSI-X\_XXXX\_XX-DR-ZL-6022

© Crown copyright and database rights 2022. Use of this data is subject to terms and conditions. Ordnance Survey Licence 100030649.



BASINGSTOKE

NOTES

Purpose of use  
**APPLICATION SUBMISSION**

Development Consent Order Number / Document  
TR010055/2.11

- THIS DRAWING HAS BEEN PRODUCED USING CAD SOFTWARE. THEREFORE ALL DIMENSIONS ARE SHOWN IN METRES UNLESS SHOWN OTHERWISE.
- DO NOT SCALE FROM THIS DRAWING. USE ONLY PRINTED DIMENSIONS.
- PROPOSED EARTHWORK EMBANKMENTS / CUTTINGS HAVE BEEN OMITTED FOR CLARITY.
- THE DESIGN SHOWN WILL BE SUBJECT TO DETAILED DESIGN DEVELOPMENT IN ACCORDANCE WITH THE PROVISIONS OF THE DEVELOPMENT CONSENT ORDER.

KEY TO SYMBOLS

- DEVELOPMENT CONSENT ORDER BOUNDARY
- LAND NOT INCLUDED IN ORDER LIMITS
- PROPOSED HIGHWAY WORK OUTLINE
- PROPOSED ROAD MARKINGS
- PROPOSED CLEARWAY EXTENTS
- PROPOSED PROHIBITION OF OVERTAKING EXTENTS

START / END POINT OF RESTRICTION AS DETAILED IN SCHEDULE 3 OF THE DEVELOPMENT CONSENT ORDER



0	NOVEMBER 2022	APPLICATION SUBMISSION	GP	LC	MF
REV	DATE	REVISION NOTE	ORIG	CHKD	APPD

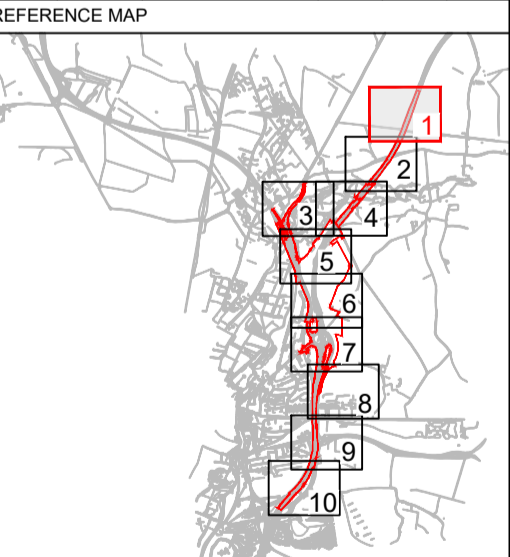

DESIGNER



CONTRACTOR



CLIENT



PROJECT TITLE

M3 JUNCTION 9 IMPROVEMENT SCHEME

PROJECT STAGE

PCF STAGE 3

DRAWING TITLE

TRAFFIC REGULATION MEASURES  
APFP REGULATION s(2)(o)  
SHEET 1 OF 10  
DOCUMENT REFERENCE: 2.11

SUITABILITY

APPLICATION SUBMISSION

SHEET SIZE: A1 SCALE: 1:1250 STATUS: REV 0

DRAWING NUMBER  
HES51511-VFK-LSI-X\_XXXX\_XX-DR-ZL-8023

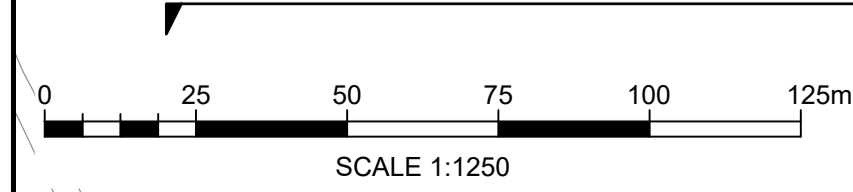

FOR CONTINUATION SHEET 2 OF 10

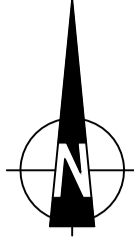

FOR CONTINUATION SHEET 1 OF 10

NOTES

Purpose of use  
**APPLICATION SUBMISSION**

Development Consent Order Number / Document  
 TR010055/2.11

- THIS DRAWING HAS BEEN PRODUCED USING CAD SOFTWARE. THEREFORE ALL DIMENSIONS ARE SHOWN IN METRES UNLESS SHOWN OTHERWISE.
- DO NOT SCALE FROM THIS DRAWING. USE ONLY PRINTED DIMENSIONS.
- PROPOSED EARTHWORK EMBANKMENTS / CUTTINGS HAVE BEEN OMITTED FOR CLARITY.
- THE DESIGN SHOWN WILL BE SUBJECT TO DETAILED DESIGN DEVELOPMENT IN ACCORDANCE WITH THE PROVISIONS OF THE DEVELOPMENT CONSENT ORDER.

KEY TO SYMBOLS

- DEVELOPMENT CONSENT ORDER BOUNDARY
- LAND NOT INCLUDED IN ORDER LIMITS
- PROPOSED HIGHWAY WORK OUTLINE
- PROPOSED ROAD MARKINGS
- PROPOSED CLEARWAY EXTENTS
- PROPOSED PROHIBITION OF OVERTAKING EXTENTS

START / END POINT OF RESTRICTION AS DETAILED IN SCHEDULE 3 OF THE DEVELOPMENT CONSENT ORDER

ABBOTS WORTHY

B3047

M3

B3047

B3047

RIVER ITCHEN

RIVER ITCHEN

FOR CONTINUATION SHEET 3 OF 10

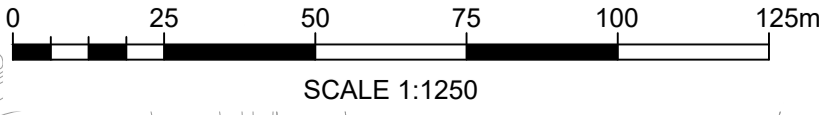

REV	DATE	REVISION NOTE	ORIG	CHKD	APPD
0	NOVEMBER 2022	APPLICATION SUBMISSION	GP	LC	MF

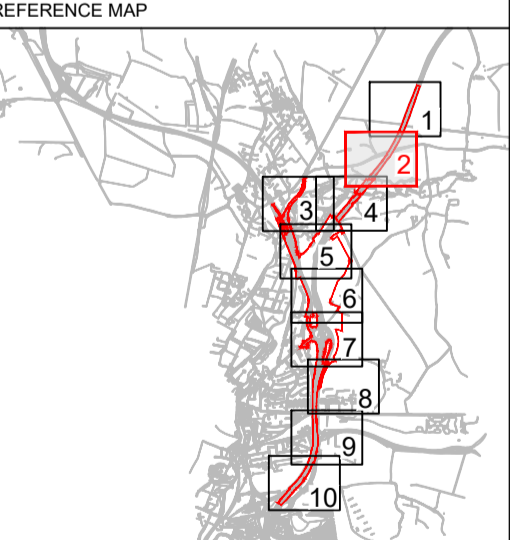

DESIGNER

CONTRACTOR

CLIENT

PROJECT TITLE  
M3 JUNCTION 9 IMPROVEMENT SCHEME

PROJECT STAGE  
PCF STAGE 3

DRAWING TITLE  
 TRAFFIC REGULATION MEASURES  
 APPFP REGULATION 5(2)(c)  
 SHEET 2 OF 10  
 DOCUMENT REFERENCE: 2.11

SUITABILITY  
 APPLICATION SUBMISSION

SHEET SIZE: A1 SCALE: 1:1250 STATUS: REV 0  
 DRAWING NUMBER  
 HES51511-VFK-LSI-X\_XXXX\_XX-DR-ZL-8024

© Crown copyright and database rights 2022. Use of this data is subject to terms and conditions. Ordnance Survey Licence 100030449

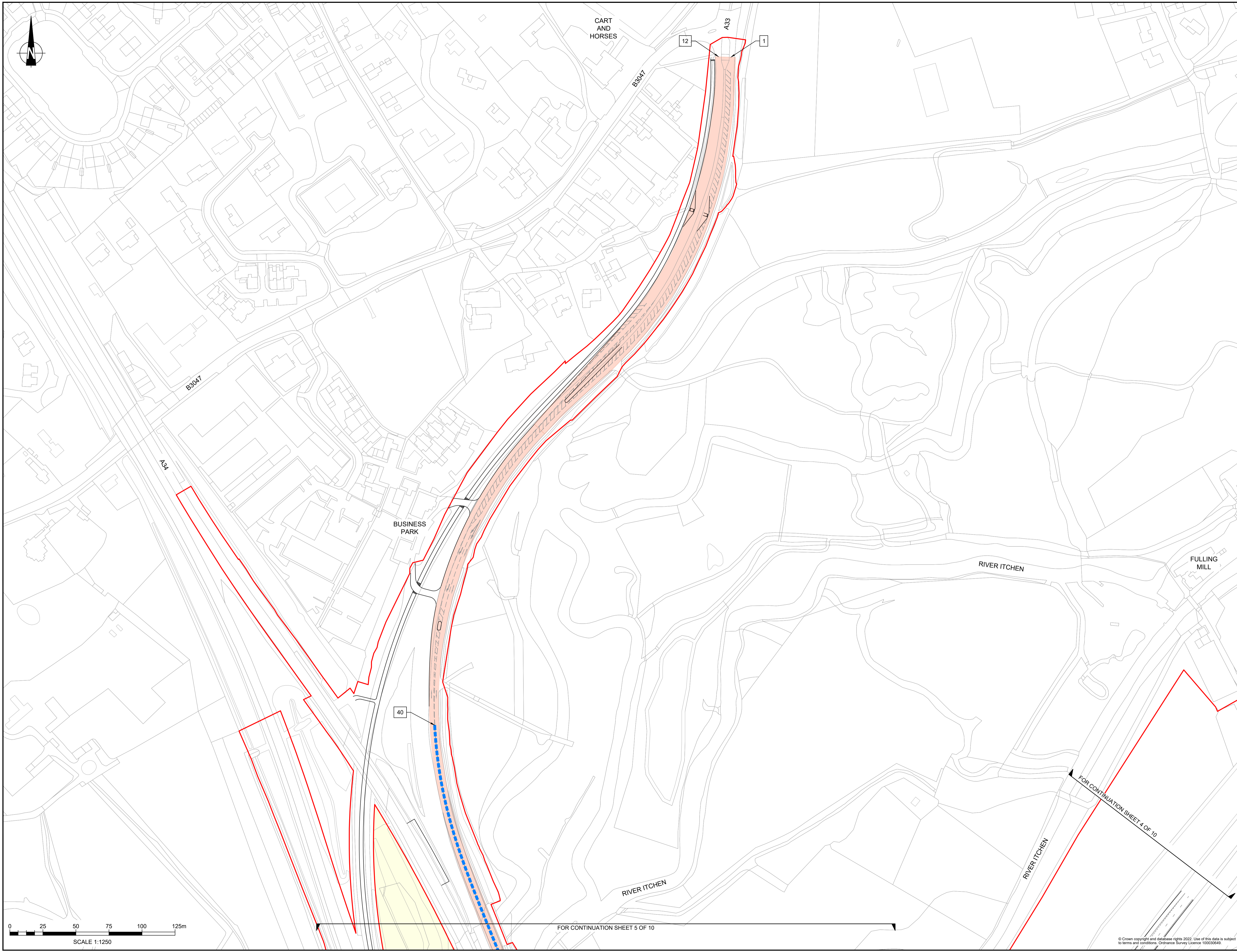

NOTES

Purpose of use  
**APPLICATION SUBMISSION**

Development Consent Order Number / Document  
 TR010055/2.11

- THIS DRAWING HAS BEEN PRODUCED USING CAD SOFTWARE. THEREFORE ALL DIMENSIONS ARE SHOWN IN METRES UNLESS SHOWN OTHERWISE.
- DO NOT SCALE FROM THIS DRAWING. USE ONLY PRINTED DIMENSIONS.
- PROPOSED EARTHWORK EMBANKMENTS / CUTTINGS HAVE BEEN OMITTED FOR CLARITY.
- THE DESIGN SHOWN WILL BE SUBJECT TO DETAILED DESIGN DEVELOPMENT IN ACCORDANCE WITH THE PROVISIONS OF THE DEVELOPMENT CONSENT ORDER.

KEY TO SYMBOLS

- DEVELOPMENT CONSENT ORDER BOUNDARY
- LAND NOT INCLUDED IN ORDER LIMITS
- PROPOSED HIGHWAY WORK OUTLINE
- PROPOSED ROAD MARKINGS
- PROPOSED CLEARWAY EXTENTS
- PROPOSED PROHIBITION OF OVERTAKING EXTENTS

START / END POINT OF RESTRICTION AS DETAILED IN SCHEDULE 3 OF THE DEVELOPMENT CONSENT ORDER

REV	DATE	REVISION NOTE	ORIG	CHKD	APPD
0	NOVEMBER 2022	APPLICATION SUBMISSION	GP	LC	MF

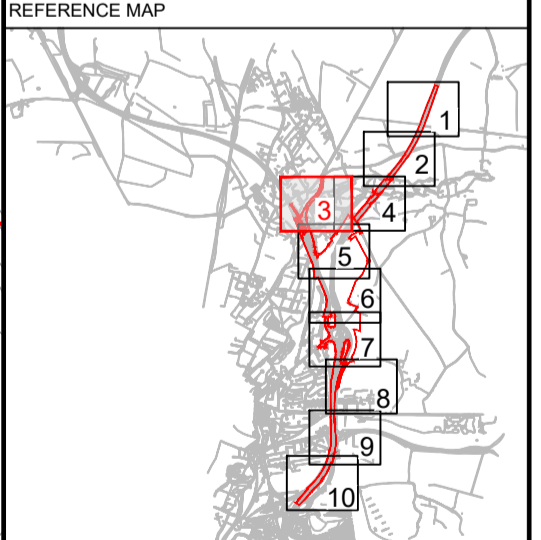

DESIGNER  
**Stantec**

CONTRACTOR  
**VolkerFitzpatrick**

CLIENT  
**national highways**

PROJECT TITLE  
 M3 JUNCTION 9 IMPROVEMENT SCHEME

PROJECT STAGE  
 PCF STAGE 3

DRAWING TITLE  
 TRAFFIC REGULATION MEASURES  
 APPP REGULATION S(2)(c)  
 SHEET 3 OF 10  
 DOCUMENT REFERENCE: 2.11

SUITABILITY  
 APPLICATION SUBMISSION

SHEET SIZE: A1 SCALE: 1:1,250 STATUS: REV 0

DRAWING NUMBER  
 HES51511-VFK-LSI-X\_XXXX\_XX-DR-ZL-8025

FOR CONTINUATION SHEET 5 OF 10

FOR CONTINUATION SHEET 4 OF 10

© Crown copyright and database rights 2022. Use of this data is subject to terms and conditions. Ordnance Survey Licence: 100030449

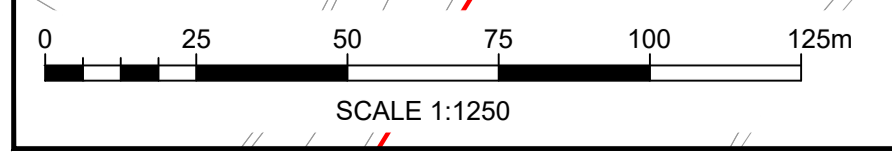
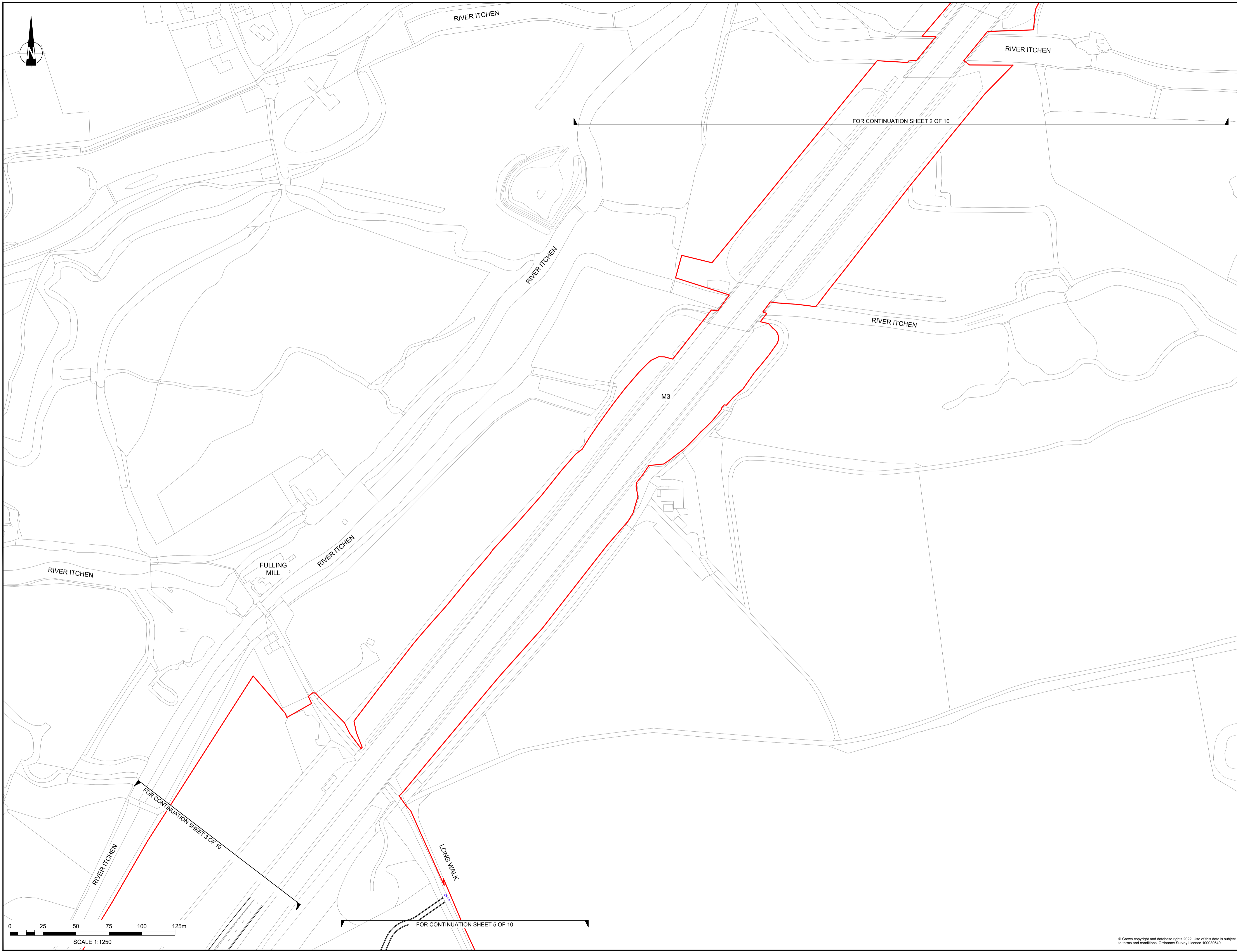

NOTES

Purpose of use  
**APPLICATION SUBMISSION**

Development Consent Order Number / Document  
 TR010055/2.11

- THIS DRAWING HAS BEEN PRODUCED USING CAD SOFTWARE. THEREFORE ALL DIMENSIONS ARE SHOWN IN METRES UNLESS SHOWN OTHERWISE.
- DO NOT SCALE FROM THIS DRAWING. USE ONLY PRINTED DIMENSIONS.
- PROPOSED EARTHWORK EMBANKMENTS / CUTTINGS HAVE BEEN OMITTED FOR CLARITY.
- THE DESIGN SHOWN WILL BE SUBJECT TO DETAILED DESIGN DEVELOPMENT IN ACCORDANCE WITH THE PROVISIONS OF THE DEVELOPMENT CONSENT ORDER.

KEY TO SYMBOLS

- DEVELOPMENT CONSENT ORDER BOUNDARY
- LAND NOT INCLUDED IN ORDER LIMITS
- PROPOSED HIGHWAY WORK OUTLINE
- PROPOSED ROAD MARKINGS
- PROPOSED CLEARWAY EXTENTS
- PROPOSED PROHIBITION OF OVERTAKING EXTENTS
- START / END POINT OF RESTRICTION AS DETAILED IN SCHEDULE 3 OF THE DEVELOPMENT CONSENT ORDER

REV	DATE	REVISION NOTE	ORIG	CHKD	APPD
0	NOVEMBER 2022	APPLICATION SUBMISSION	GP	LC	MF

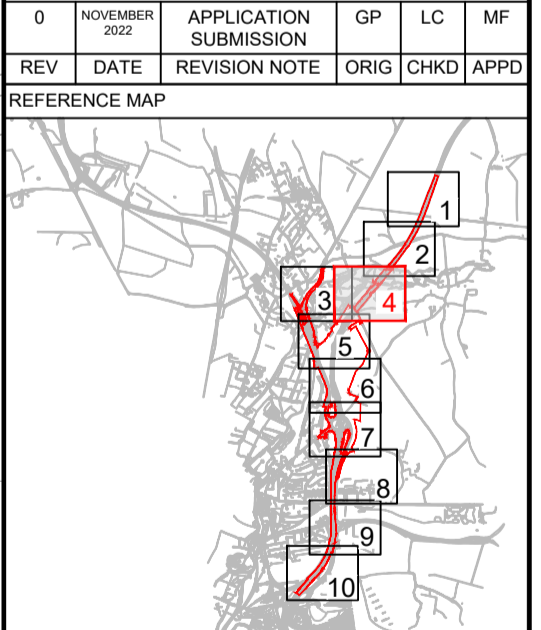

DESIGNER  
**Stantec**

CONTRACTOR  
**VolkerFitzpatrick**

CLIENT  
**national highways**

PROJECT TITLE  
 M3 JUNCTION 9 IMPROVEMENT SCHEME

PROJECT STAGE  
 PCF STAGE 3

DRAWING TITLE  
 TRAFFIC REGULATION MEASURES  
 APPP REGULATION S(2)(c)  
 SHEET 4 OF 10  
 DOCUMENT REFERENCE: 2.11

SUITABILITY  
 APPLICATION SUBMISSION

SHEET SIZE: A1    SCALE: 1:1250    STATUS: REV 0

DRAWING NUMBER  
 HES51511-VFK-LSI-X\_XXXX\_XX-DR-ZL-8026

© Crown copyright and database rights 2022. Use of this data is subject to terms and conditions. Ordnance Survey Licence 100030490

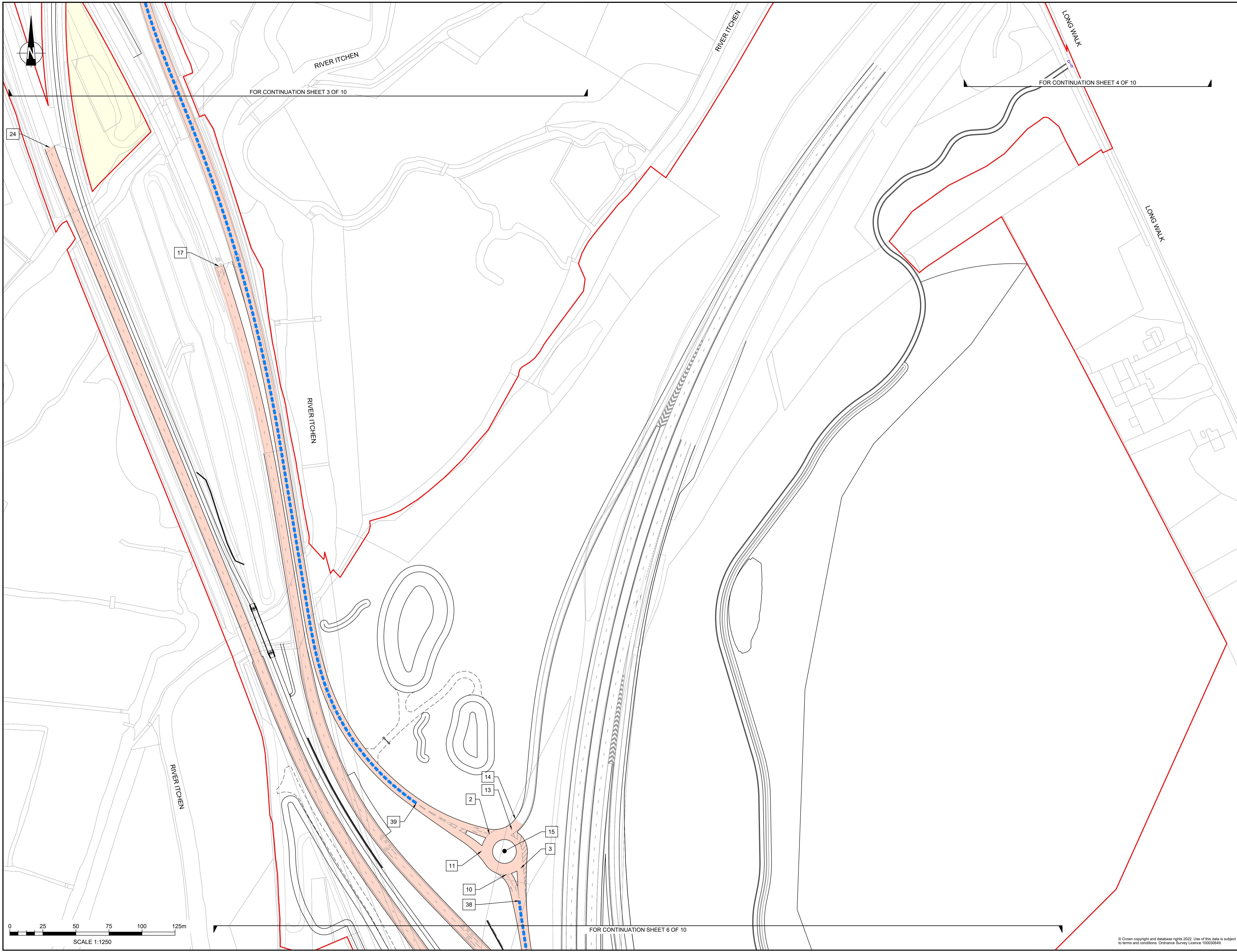

**NOTES**

Purpose of use  
**APPLICATION SUBMISSION**

Development Consent Order Number / Document  
**TR010055/2.11**

- THIS DRAWING HAS BEEN PRODUCED USING CAD SOFTWARE. THEREFORE ALL DIMENSIONS ARE SHOWN IN METRES UNLESS SHOWN OTHERWISE.
- DO NOT SCALE FROM THIS DRAWING. USE ONLY PRINTED DIMENSIONS.
- PROPOSED EARTHWORK EMBANKMENTS / CUTTINGS HAVE BEEN OMITTED FOR CLARITY.
- THE DESIGN SHOWN WILL BE SUBJECT TO DETAILED DESIGN DEVELOPMENT IN ACCORDANCE WITH THE PROVISIONS OF THE DEVELOPMENT CONSENT ORDER.

**KEY TO SYMBOLS**

- DEVELOPMENT CONSENT ORDER BOUNDARY
- LAND NOT INCLUDED IN ORDER LIMITS
- PROPOSED HIGHWAY WORK OUTLINE
- PROPOSED ROAD MARKINGS
- PROPOSED CLEARWAY EXTENTS
- PROPOSED PROHIBITION OF OVERTAKING EXTENTS
- START / END POINT OF RESTRICTION AS DETAILED IN SCHEDULE 3 OF THE DEVELOPMENT CONSENT ORDER

REV	DATE	REVISION NOTE	ORIG	CHKD	APPD
0	NOVEMBER 2022	APPLICATION SUBMISSION	GP	LC	MF

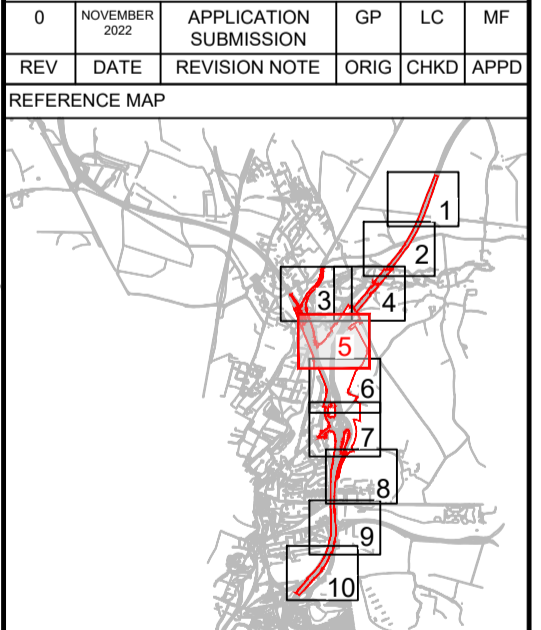

**DESIGNER**

**CONTRACTOR**

**CLIENT**

**PROJECT TITLE**  
**M3 JUNCTION 9 IMPROVEMENT SCHEME**

**PROJECT STAGE**  
**PCF STAGE 3**

**DRAWING TITLE**  
**TRAFFIC REGULATION MEASURES  
 APFP REGULATION S(2)(c)  
 SHEET 5 OF 10  
 DOCUMENT REFERENCE: 2.11**

**SUITABILITY**  
**APPLICATION SUBMISSION**

SHEET SIZE: A1    SCALE: 1:1250    STATUS: REV 0

**DRAWING NUMBER**  
 HES51511-VFK-LSI-X\_XXXX\_XX-DR-ZL-6027

© Crown copyright and database rights 2022. Use of this data is subject to terms and conditions. Ordnance Survey Licence 100030649.

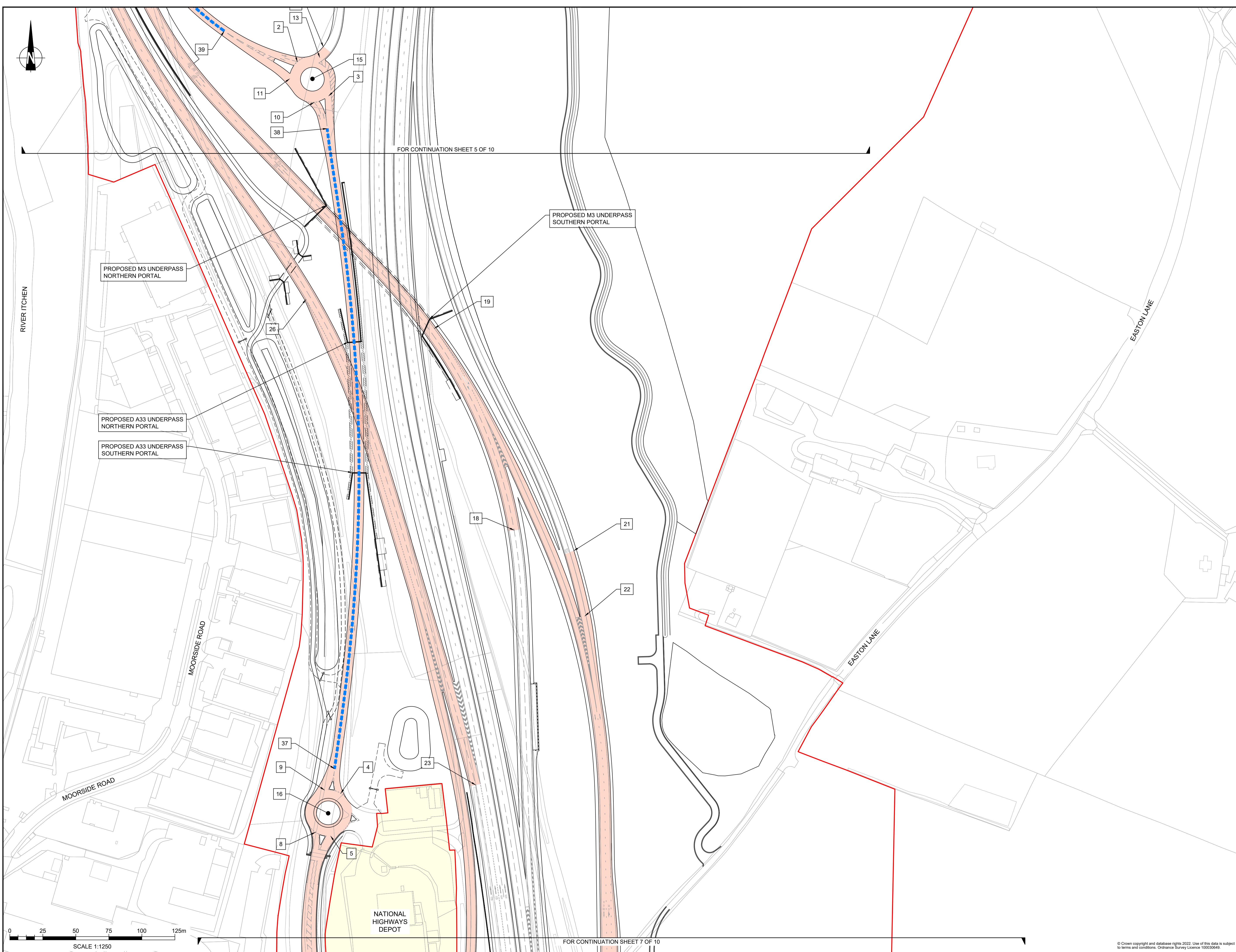

FOR CONTINUATION SHEET 5 OF 10

PROPOSED M3 UNDERPASS  
SOUTHERN PORTAL

PROPOSED M3 UNDERPASS  
NORTHERN PORTAL

PROPOSED A33 UNDERPASS  
NORTHERN PORTAL

PROPOSED A33 UNDERPASS  
SOUTHERN PORTAL

NATIONAL  
HIGHWAYS  
DEPOT

FOR CONTINUATION SHEET 7 OF 10

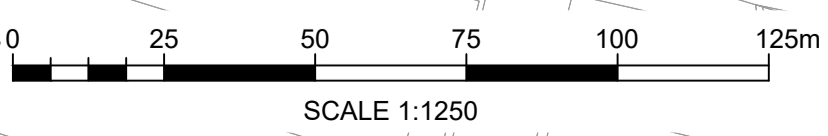
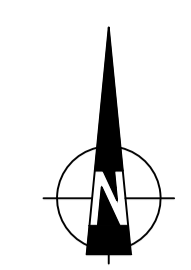

NOTES

Purpose of use  
**APPLICATION SUBMISSION**

Development Consent Order Number / Document  
TR010055/2.11

- THIS DRAWING HAS BEEN PRODUCED USING CAD SOFTWARE. THEREFORE ALL DIMENSIONS ARE SHOWN IN METRES UNLESS SHOWN OTHERWISE.
- DO NOT SCALE FROM THIS DRAWING. USE ONLY PRINTED DIMENSIONS.
- PROPOSED EARTHWORK EMBANKMENTS / CUTTINGS HAVE BEEN OMITTED FOR CLARITY.
- THE DESIGN SHOWN WILL BE SUBJECT TO DETAILED DESIGN DEVELOPMENT IN ACCORDANCE WITH THE PROVISIONS OF THE DEVELOPMENT CONSENT ORDER.

KEY TO SYMBOLS

- DEVELOPMENT CONSENT ORDER BOUNDARY
- LAND NOT INCLUDED IN ORDER LIMITS
- PROPOSED HIGHWAY WORK OUTLINE
- PROPOSED ROAD MARKINGS
- PROPOSED CLEARWAY EXTENTS
- PROPOSED PROHIBITION OF OVERTAKING EXTENTS

START / END POINT OF RESTRICTION AS DETAILED IN SCHEDULE 3 OF THE DEVELOPMENT CONSENT ORDER

REV	DATE	REVISION NOTE	ORIG	CHKD	APPD
0	NOVEMBER 2022	APPLICATION SUBMISSION	GP	LC	MF

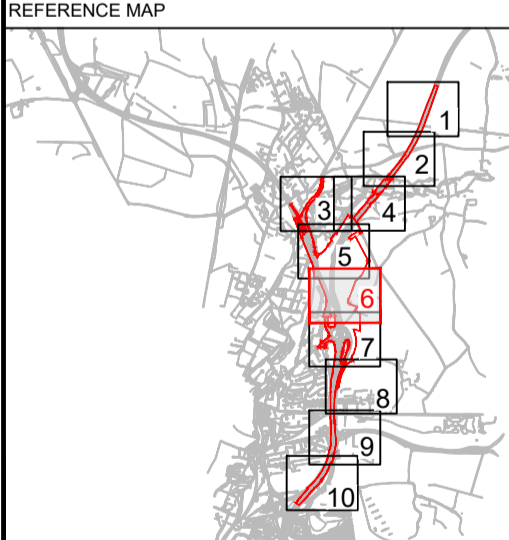

DESIGNER  
**Stantec**

CONTRACTOR  
**VolkerFitzpatrick**

CLIENT  
**national highways**

PROJECT TITLE  
M3 JUNCTION 9 IMPROVEMENT SCHEME

PROJECT STAGE  
PCF STAGE 3

DRAWING TITLE  
TRAFFIC REGULATION MEASURES  
APFP REGULATION 5(2)(c)  
SHEET 6 OF 10  
DOCUMENT REFERENCE: 2.11

SUITABILITY  
APPLICATION SUBMISSION

SHEET SIZE: A1 SCALE: 1:1,250 STATUS: REV 0  
DRAWING NUMBER  
HES51511-VFK-LSI-X\_XXXX\_XX-DR-ZL-6028

© Crown copyright and database rights 2022. Use of this data is subject to terms and conditions. Ordnance Survey Licence 100030649.



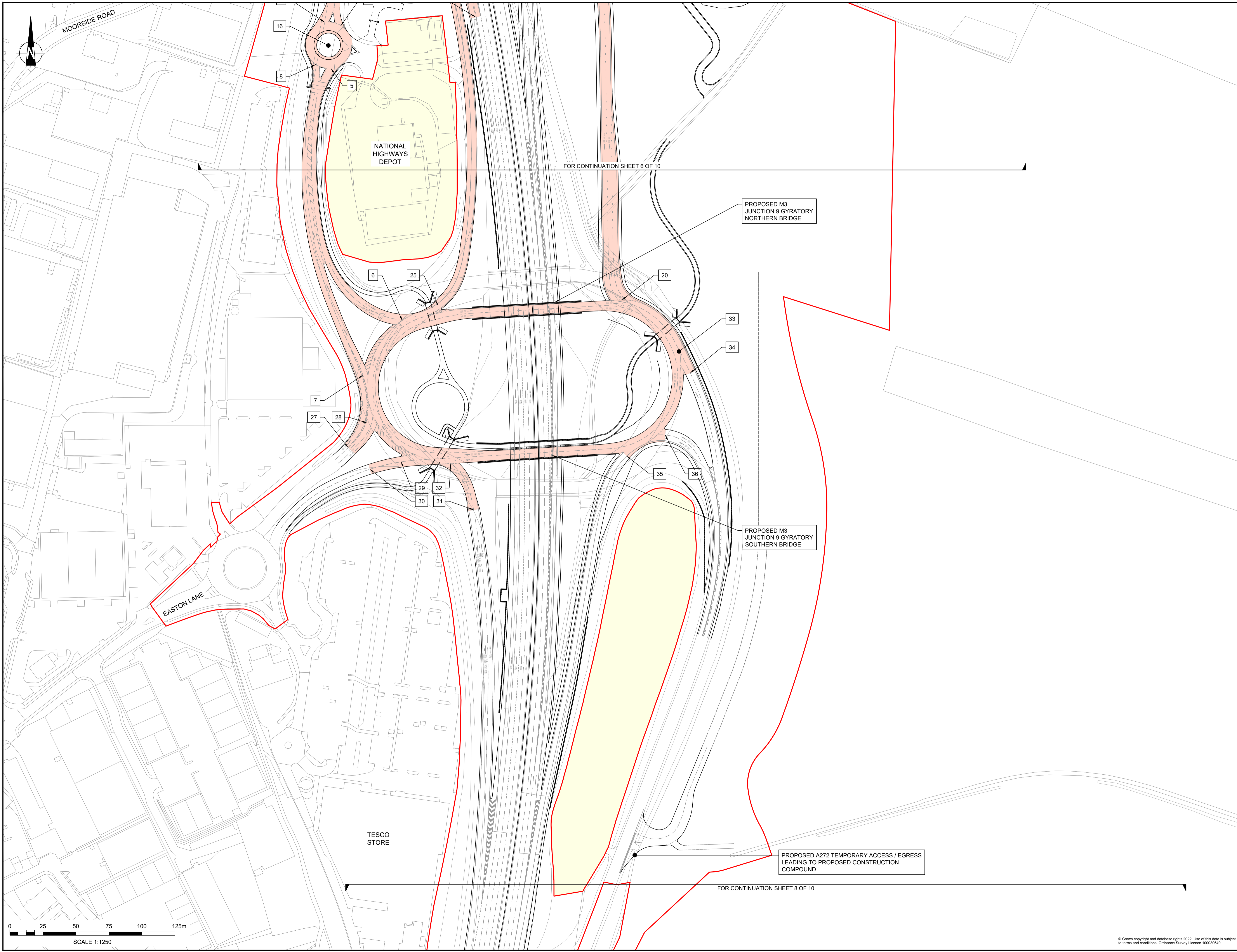

FOR CONTINUATION SHEET 6 OF 10

FOR CONTINUATION SHEET 8 OF 10

**NOTES**  
 Purpose of use  
**APPLICATION SUBMISSION**  
 Development Consent Order Number / Document  
 TR01005/2.11

- THIS DRAWING HAS BEEN PRODUCED USING CAD SOFTWARE. THEREFORE ALL DIMENSIONS ARE SHOWN IN METRES UNLESS SHOWN OTHERWISE.
- DO NOT SCALE FROM THIS DRAWING. USE ONLY PRINTED DIMENSIONS.
- PROPOSED EARTHWORK EMBANKMENTS / CUTTINGS HAVE BEEN OMITTED FOR CLARITY.
- THE DESIGN SHOWN WILL BE SUBJECT TO DETAILED DESIGN DEVELOPMENT IN ACCORDANCE WITH THE PROVISIONS OF THE DEVELOPMENT CONSENT ORDER.

**KEY TO SYMBOLS**

- DEVELOPMENT CONSENT ORDER BOUNDARY
- LAND NOT INCLUDED IN ORDER LIMITS
- PROPOSED HIGHWAY WORK OUTLINE
- PROPOSED ROAD MARKINGS
- PROPOSED CLEARWAY EXTENTS
- PROPOSED PROHIBITION OF OVERTAKING EXTENTS
- START / END POINT OF RESTRICTION AS DETAILED IN SCHEDULE 3 OF THE DEVELOPMENT CONSENT ORDER

REV	DATE	REVISION NOTE	ORIG	CHKD	APPD
0	NOVEMBER 2022	APPLICATION SUBMISSION	GP	LC	MF

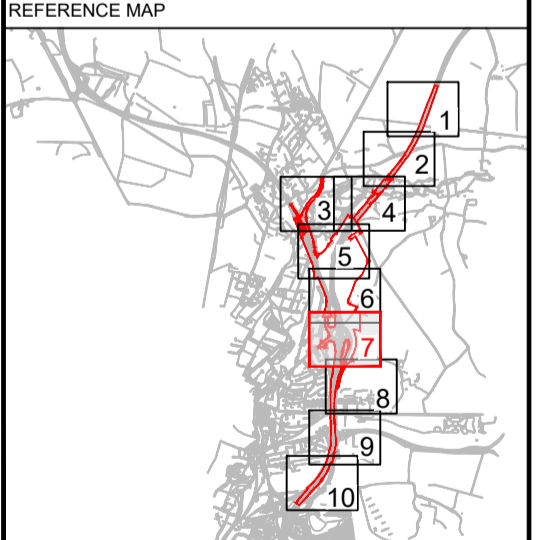

**DESIGNER**  
 Stantec

**CONTRACTOR**  
 VolkerFitzpatrick

**CLIENT**  
 national highways

**PROJECT TITLE**  
 M3 JUNCTION 9 IMPROVEMENT SCHEME

**PROJECT STAGE**  
 PCF STAGE 3

**DRAWING TITLE**  
 TRAFFIC REGULATION MEASURES  
 APPP REGULATION 5(2)(c)  
 SHEET 7 OF 10  
 DOCUMENT REFERENCE: 2.11

**SUITABILITY**  
 APPLICATION SUBMISSION

SHEET SIZE: A1    SCALE: 1:1250    STATUS: REV 0

DRAWING NUMBER  
 HES51511-VFK-LSI-X\_XXXX\_XX-DR-ZL-8029

© Crown copyright and database rights 2022. Use of this data is subject to terms and conditions. Ordnance Survey Licence 100030649



TESCO STORE

FOR CONTINUATION SHEET 7 OF 10

ST SWITHUN'S SCHOOL

FOR CONTINUATION SHEET 9 OF 10

ALRESFORD ROAD

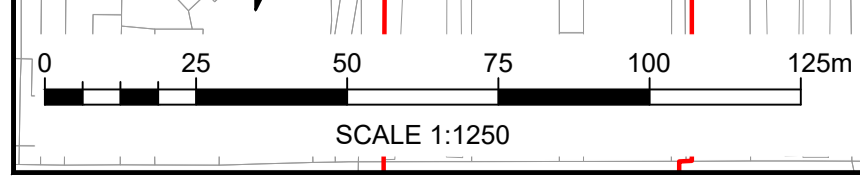

NOTES

Purpose of use  
**APPLICATION SUBMISSION**

Development Consent Order Number / Document  
**TR010055/2.11**

- THIS DRAWING HAS BEEN PRODUCED USING CAD SOFTWARE. THEREFORE ALL DIMENSIONS ARE SHOWN IN METRES UNLESS SHOWN OTHERWISE.
- DO NOT SCALE FROM THIS DRAWING. USE ONLY PRINTED DIMENSIONS.
- PROPOSED EARTHWORK EMBANKMENTS / CUTTINGS HAVE BEEN OMITTED FOR CLARITY.
- THE DESIGN SHOWN WILL BE SUBJECT TO DETAILED DESIGN DEVELOPMENT IN ACCORDANCE WITH THE PROVISIONS OF THE DEVELOPMENT CONSENT ORDER.

KEY TO SYMBOLS

- DEVELOPMENT CONSENT ORDER BOUNDARY
- LAND NOT INCLUDED IN ORDER LIMITS
- PROPOSED HIGHWAY WORK OUTLINE
- PROPOSED ROAD MARKINGS
- PROPOSED CLEARWAY EXTENTS
- PROPOSED PROHIBITION OF OVERTAKING EXTENTS

START / END POINT OF RESTRICTION AS DETAILED IN SCHEDULE 3 OF THE DEVELOPMENT CONSENT ORDER

0	NOVEMBER 2022	APPLICATION SUBMISSION	GP	LC	MF
REV	DATE	REVISION NOTE	ORIG	CHKD	APPD

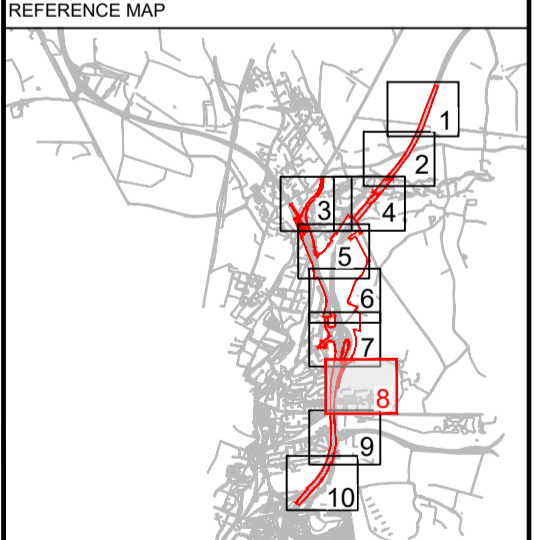

DESIGNER  
**Stantec**

CONTRACTOR  
**VolkerFitzpatrick**

CLIENT  
**national highways**

PROJECT TITLE  
**M3 JUNCTION 9 IMPROVEMENT SCHEME**

PROJECT STAGE  
**PCF STAGE 3**

DRAWING TITLE  
**TRAFFIC REGULATION MEASURES  
APFP REGULATION S(2)(c)  
SHEET 8 OF 10  
DOCUMENT REFERENCE: 2.11**

SUITABILITY  
**APPLICATION SUBMISSION**

SHEET SIZE: A1    SCALE: 1:1250    STATUS: REV 0

DRAWING NUMBER  
HES51511-VFK-LSI-X\_XXXX\_XX-DR-ZL-8030

© Crown copyright and database rights 2022. Use of this data is subject to terms and conditions. Ordnance Survey Licence 10003049

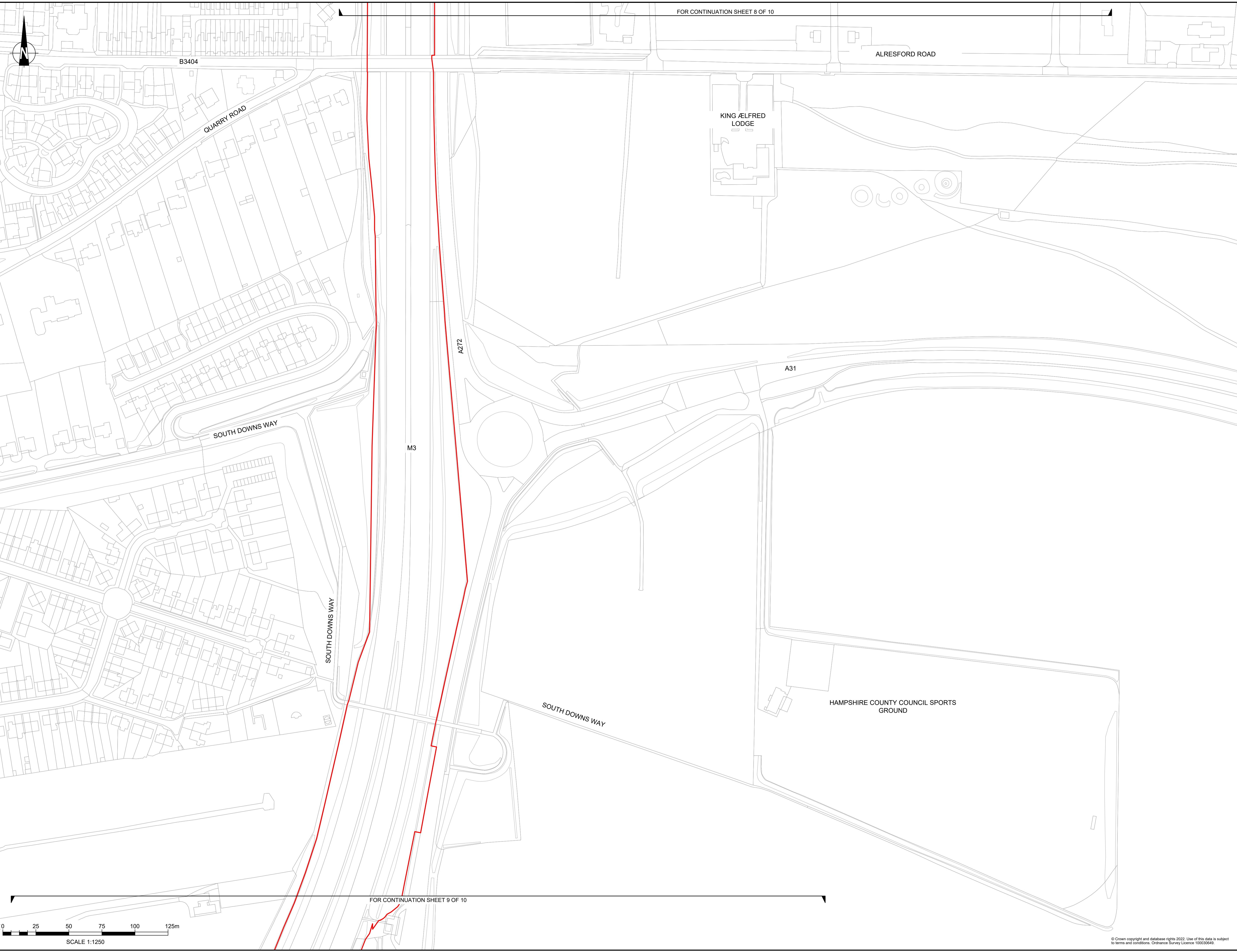

NOTES

Purpose of use  
**APPLICATION SUBMISSION**

Development Consent Order Number / Document  
 TR010055/2.11

- THIS DRAWING HAS BEEN PRODUCED USING CAD SOFTWARE. THEREFORE ALL DIMENSIONS ARE SHOWN IN METRES UNLESS SHOWN OTHERWISE.
- DO NOT SCALE FROM THIS DRAWING. USE ONLY PRINTED DIMENSIONS.
- PROPOSED EARTHWORK EMBANKMENTS / CUTTINGS HAVE BEEN OMITTED FOR CLARITY.
- THE DESIGN SHOWN WILL BE SUBJECT TO DETAILED DESIGN DEVELOPMENT IN ACCORDANCE WITH THE PROVISIONS OF THE DEVELOPMENT CONSENT ORDER.

KEY TO SYMBOLS

- DEVELOPMENT CONSENT ORDER BOUNDARY
- LAND NOT INCLUDED IN ORDER LIMITS
- PROPOSED HIGHWAY WORK OUTLINE
- PROPOSED ROAD MARKINGS
- PROPOSED CLEARWAY EXTENTS
- PROPOSED PROHIBITION OF OVERTAKING EXTENTS
- START / END POINT OF RESTRICTION AS DETAILED IN SCHEDULE 3 OF THE DEVELOPMENT CONSENT ORDER

REV	DATE	REVISION NOTE	ORIG	CHKD	APPD
0	NOVEMBER 2022	APPLICATION SUBMISSION	GP	LC	MF

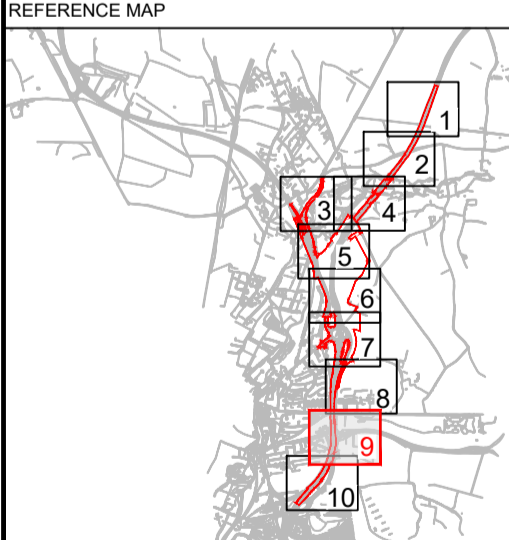

DESIGNER

CONTRACTOR

CLIENT

PROJECT TITLE  
 M3 JUNCTION 9 IMPROVEMENT SCHEME

PROJECT STAGE  
 PCF STAGE 3

DRAWING TITLE  
 TRAFFIC REGULATION MEASURES  
 APPP REGULATION S(2)(c)  
 SHEET 9 OF 10  
 DOCUMENT REFERENCE: 2.11

SUITABILITY  
 APPLICATION SUBMISSION

SHEET SIZE: A1 | SCALE: 1:1,250 | STATUS: REV 0

DRAWING NUMBER  
 HES51511-VFK-LSI-X\_XXXX\_XX-DR-ZL-8031

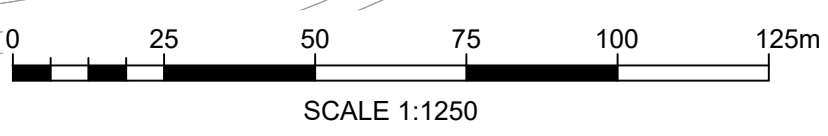

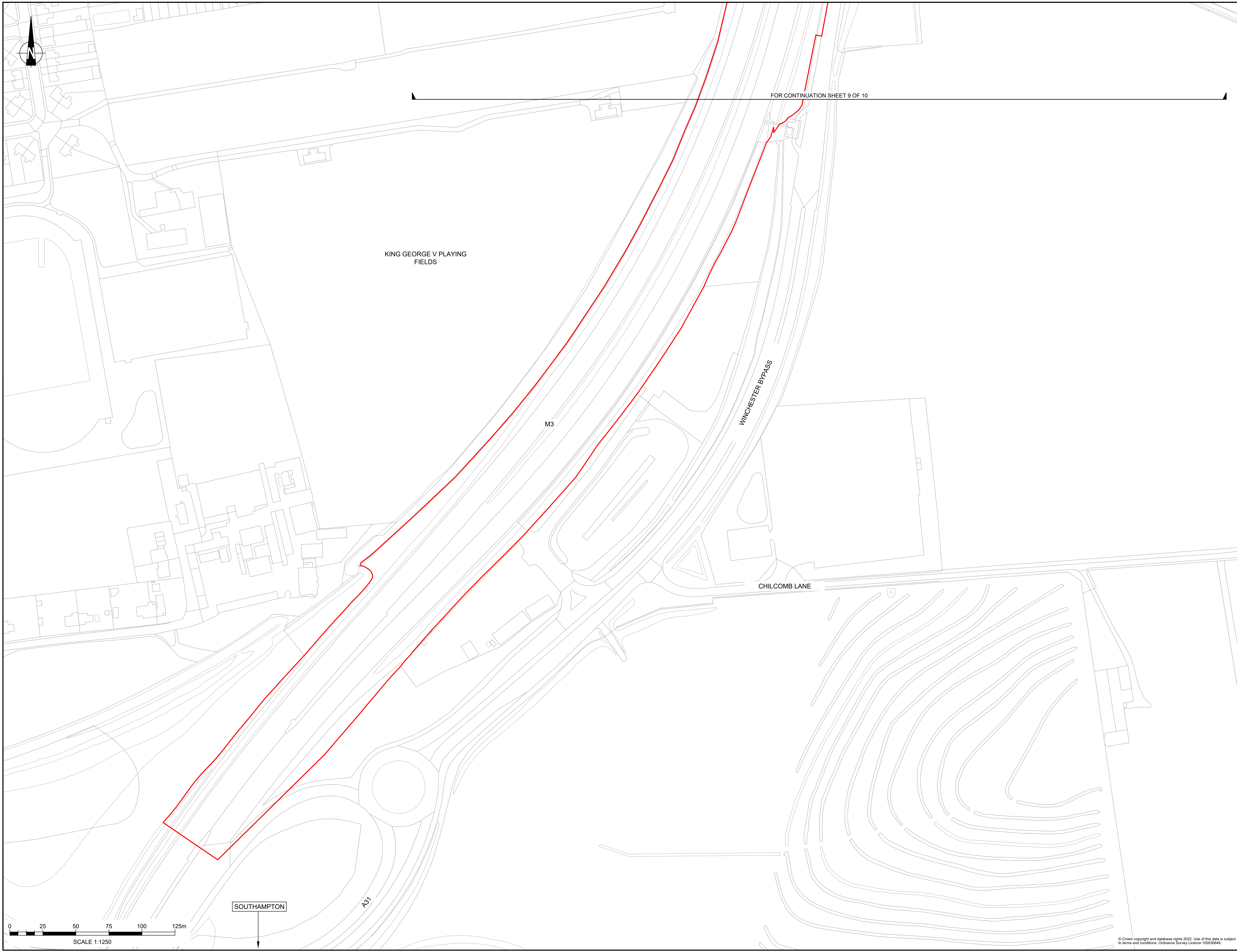

FOR CONTINUATION SHEET 9 OF 10

KING GEORGE V PLAYING FIELDS

WINCHESTER BYPASS

CHILCOMB LANE

SOUTHAMPTON

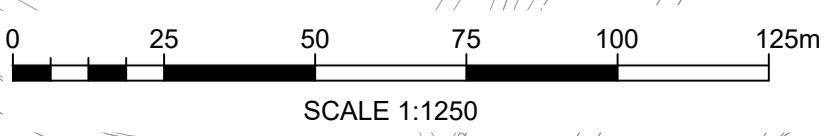

NOTES

Purpose of use  
**APPLICATION SUBMISSION**  
 Development Consent Order Number / Document  
 TR010055/2.11

- THIS DRAWING HAS BEEN PRODUCED USING CAD SOFTWARE. THEREFORE ALL DIMENSIONS ARE SHOWN IN METRES UNLESS SHOWN OTHERWISE.
- DO NOT SCALE FROM THIS DRAWING. USE ONLY PRINTED DIMENSIONS.
- PROPOSED EARTHWORK EMBANKMENTS / CUTTINGS HAVE BEEN OMITTED FOR CLARITY.
- THE DESIGN SHOWN WILL BE SUBJECT TO DETAILED DESIGN DEVELOPMENT IN ACCORDANCE WITH THE PROVISIONS OF THE DEVELOPMENT CONSENT ORDER.

KEY TO SYMBOLS

- DEVELOPMENT CONSENT ORDER BOUNDARY
- LAND NOT INCLUDED IN ORDER LIMITS
- PROPOSED HIGHWAY WORK OUTLINE
- PROPOSED ROAD MARKINGS
- PROPOSED CLEARWAY EXTENTS
- PROPOSED PROHIBITION OF OVERTAKING EXTENTS
- START / END POINT OF RESTRICTION AS DETAILED IN SCHEDULE 3 OF THE DEVELOPMENT CONSENT ORDER

REV	DATE	REVISION NOTE	ORIG	CHKD	APPD
0	NOVEMBER 2022	APPLICATION SUBMISSION	GP	LC	MF

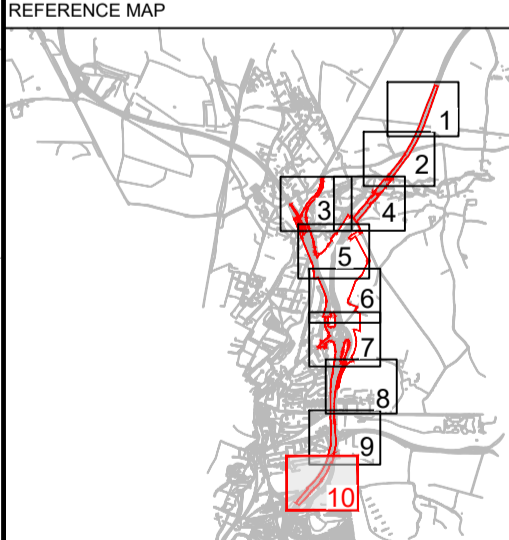

DESIGNER

CONTRACTOR

CLIENT

PROJECT TITLE  
 M3 JUNCTION 9 IMPROVEMENT SCHEME

PROJECT STAGE  
 PCF STAGE 3

DRAWING TITLE  
 TRAFFIC REGULATION MEASURES  
 APPP REGULATION S(2)(c)  
 SHEET 10 OF 10  
 DOCUMENT REFERENCE: 2.11

SUITABILITY  
 APPLICATION SUBMISSION  
 SHEET SIZE: A1 SCALE: 1:1250 STATUS: REV 0  
 DRAWING NUMBER  
 HES51511-VFK-LSI-X\_XXXX\_XX-DR-ZL-8032

© Crown copyright and database rights 2022. Use of this data is subject to terms and conditions. Ordnance Survey Licence 100030649